

Dielectric Unions

Product Specifications



FEATURES

- Sizes 1/2"–2"
- Female Iron Pipe threads to Sweat connection
- Max 10uA measured at 600 Volts AC
- Max 3uA measured at 2000 Volts DC
- EPDM Gasket high temp applications:
 - 300°F @ 50 psi
 - 180°F @ 250 psi
- ≤ .25% Pb



✓ To Submit	Part #	Size	A	B	Weight (oz.)
	ML3001A-12	1/2" Sweat x FIP Dielectric Union	1.67	1.63	4.8
	ML3001A-34	3/4" Sweat x FIP Dielectric Union	1.98	1.85	6.3
	ML3001A-1	1" Sweat x FIP Dielectric Union	2.28	2.13	8.8
	ML3001A-114	1-1/4" Sweat x FIP Dielectric Union	2.42	2.58	12.7
	ML3001A-112	1-1/2" Sweat x FIP Dielectric Union	2.56	2.95	19.9
	ML3001A-2	2" Sweat x FIP Dielectric Union	2.99	3.78	37
	ML3002	1/2" Sweat x 3/4" FIP Dielectric Union	1.69	1.85	6

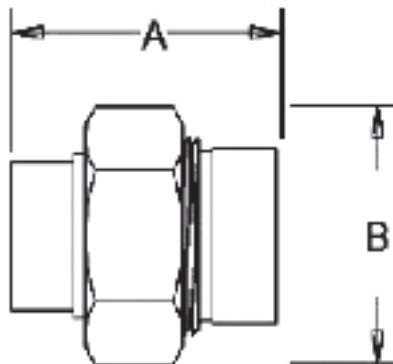

Warranty

See warranty information for more details.

All dimensions listed are nominal. MAINLINE® reserves the right to make product and material changes at any time without notice.



Contact your sales representative for more information or visit our website at mainlinecollection.com