

Wood Screw Zinc or Brass Plated

Product Specifications



PRODUCT FEATURES

- Zinc or Brass plated
- Flat head, Oval head or Round head

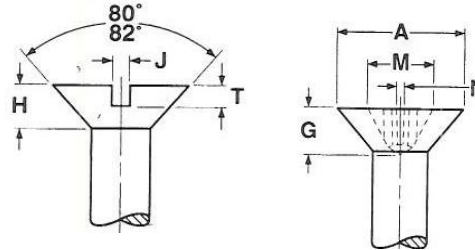

Flat Head Wood Screw												ANSI B18.6.1		
Size	A		H		T		M				G		N	Phillips Driver Size
	Head Diameter		Head Height		Depth of Slot		Dimensions of Recess							
	Min	Max	Ref	Max	Min	Max	Diameter		Depth		Width			
4	.195	.225	.067	.039	.020	.030	.115	.128	.073	.89	.018		1	
5	.220	.252	.075	.043	.022	.034	.141	.154	.063	.86	.027		2	
6	.244	.279	.083	.048	.024	.038	.161	.174	.083	.106	.029		2	
7	.268	.305	.091	.048	.027	.041	.176	.189	.098	.121	.030		2	
8	.292	.332	.100	.054	.029	.045	.191	.204	.113	.136	.032		2	
9	.316	.358	.108	.054	.032	.049	.201	.214	.123	.146	.033		2	
10	.340	.385	.116	.060	.034	.053	.245	.258	.123	.146	.034		3	
12	.389	.438	.132	.067	.039	.060	.270	.283	.148	.171	.036		3	
14	.452	.452	.153	.075	.046	.070	.270	.283	.148	.171	.036		3	

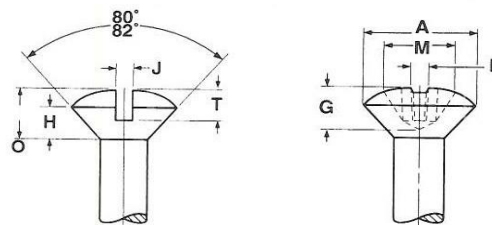

Oval Head Wood Screw													ANSI B18.6.1		
Size	A		H	O		J		T		M		G	N	Phillips Driver Size	
	Head Diameter		Side Height	Height of Head		Width of Slot		Dimensions of Recess							
	Min	Max		Ref	Min	Max	Depth of Slot		Diameter		Depth				
4	.195	.225	.067	.084	.104	.031	.039	.049	.059	.123	.136	.077	.094	1	
5	.220	.252	.075	.095	.116	.035	.043	.055	.067	.145	.158	.061	.085	2	
6	.244	.279	.083	.105	.128	.039	.048	.060	.074	.165	.178	.080	.105	2	
8	.292	.332	.100	.126	.152	.045	.054	.072	.088	.192	.205	.106	.131	2	
9	.316	.358	.108	.137	.164	.045	.054	.078	.095	.203	.216	.119	.144	2	
10	.340	.385	.116	.148	.176	.050	.060	.084	.103	.248	.261	.118	.142	3	

Warranty: See warranty information for more details.

All dimensions listed are nominal. MAINLINE® reserves the right to make product and material changes at any time without notice.

Contact your sales representative for more information or visit our website at mainlinecollection.com

Wood Screw Zinc or Brass Plated

Product Specifications

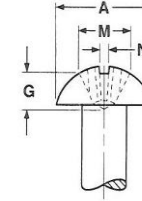
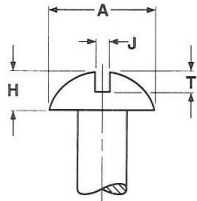

Round Head Wood Screw														ANSI B18.6.1	
Size	A		H		J		T		M		G		N	Phillips Driver Size	
	Head Diameter		Height of Head		Width of Slot		Depth of Slot		Dimensions of Recess						
	Min	Max	Min	Max	Min	Max	Min	Max	Diameter		Depth		Width		
2	.146	.162	.059	.069	.023	.031	.037	.048	.101	.114	.042	.064	.018	1	
4	.193	.211	.075	.086	.031	.039	.044	.058	.117	.130	.063	.083	.019	1	
5	.217	.236	.083	.095	.035	.043	.047	.063	.141	.154	.046	.074	.027	2	
6	.240	.260	.091	.103	.039	.048	.051	.068	.149	.162	.056	.084	0.27	2	
7	.264	.285	.099	.111	.039	.048	.055	.072	.157	.170	.066	.092	0.28	2	
8	.287	.309	.107	.120	.045	.054	.058	.077	.165	.178	.075	.101	.030	2	
9	.311	.334	.115	.128	.045	.054	.062	.082	.173	.186	.084	.110	.030	2	
10	.334	.359	.123	.137	.050	.060	.065	.087	.182	.195	.093	.119	.031	2	
12	.382	.408	.139	.153	.056	.067	.073	.096	.236	.249	.099	.125	.032	3	
14	.429	.457	.155	.170	.064	.075	.080	.106	.252	.265	.116	.142	.034	3	

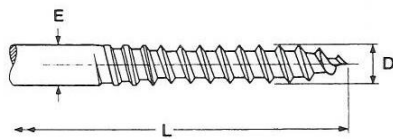

CUT THREAD

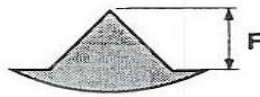

ROLLED THREAD

Thread & Body Diameter for Screws										ANSI B18.6.1	
Size	Threads per Inch (±10%)	D		E		E1		F			
		Major Thread Diameter		Body Diameter (Cut Thread)		Body Diameter (Rolled Thread)		Thread Depth			
		Min	Max	Min	Max	Min	Max	Min			
2	.086	26	.079	.090	.079	.090	.064	.075	.010		
4	.112	22	.105	.116	.105	.116	.084	.095	.016		
5	.125	20	.118	.129	.118	.129	.096	.107	.018		
6	.138	18	.131	.142	.131	.142	.107	.118	.00		
7	.151	16	.144	.155	.144	.155	.116	.127	.022		
8	.164	15	.157	.168	.157	.167	.125	.136	.023		
9	.177	14	.170	.181	.170	.181	.136	.147	.026		
10	.190	13	.183	.194	.183	.194	.146	.157	.030		
12	.216	11	.209	.220	.209	.220	.165	.176	.031		
14	.242	10	.235	.246	.235	.246	.190	.201	.035		

Tolerance On Length	Screw Length			
	Up to 5/8 in., Incl	Over 5/8 to 1-1/2 in., Incl	Over 1-1/2 to 2-3/4 in., Incl.	Over 2-3/4 in.
	+0, -0.03	+0, -0.05	+0, -0.06	+0, -0.09
Material	Commercial quality carbon steel			