

Weldless Eye Nut

Fig. 290: Right-Hand Thread

Fig. 290L: Left-Hand Thread

Size Range: $\frac{3}{8}$ " through $2\frac{1}{2}$ "

Material: Forged steel

Finish: Plain or Zinc Plated (Hot-Dip Galvanized optional)

Service: For use on high temperature piping installations.

Approvals: Complies with Federal Specification A-A-1192A (Type 17), WW-H-171-E (Type 17), ANSI/MSS SP-69 and MSS SP-58 (Type 17).

Features:

- Supports loads equal to the full limitation of the hanger rod.
- Provides flexible connection when used with straight thread rod.

Ordering: Specify rod size, figure number, name and finish. If other than standard combination of eye nut number and rod size, specify eye nut number and special rod tapping size.

Note: The acceptability of galvanized coatings at temperatures above 450°F is at the discretion of the end user. Larger eye nuts featuring smaller rod sizes are commonly available.

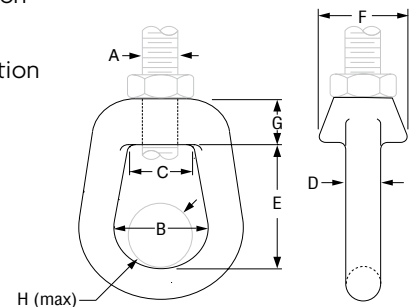

FIG. 290, 290L: LOADS (LBS) • WEIGHTS (LBS) • DIMENSIONS (IN)

Rod Size A	Max Load		Weight	B	C	D	E	F	G	H	Eye Nut Number
	650° F	750° F									
$\frac{3}{8}$	730	572	0.28	$1\frac{5}{32}$	$\frac{13}{16}$	$\frac{13}{32}$	$1\frac{17}{32}$	$\frac{31}{32}$	$\frac{5}{8}$	1	0
$\frac{1}{2}$	1,350	1,057	0.28								
$\frac{5}{8}$	2,160	1,692	0.62	$1\frac{1}{2}$	$\frac{13}{16}$	$\frac{1}{2}$	2	$\frac{13}{8}$	$\frac{11}{16}$	$1\frac{1}{4}$	1
$\frac{3}{4}$	3,230	2,530	0.60								
$\frac{7}{8}$	4,480	3,508	1.70	2	$1\frac{11}{16}$	$\frac{3}{4}$	$2\frac{5}{8}$	$1\frac{15}{16}$	1	$1\frac{3}{4}$	2
1	5,900	4,620	1.70								
$1\frac{1}{4}$	9,500	7,440	3.60	$2\frac{1}{2}$	$1\frac{13}{16}$	1	$3\frac{3}{8}$	$2\frac{3}{8}$	$1\frac{1}{4}$	$2\frac{1}{4}$	3
$1\frac{1}{2}$	13,800	10,807	3.50								
$1\frac{3}{4}$	18,600	14,566	16.40	4	4	$1\frac{1}{2}$	$6\frac{1}{4}$	4	$2\frac{1}{4}$	$3\frac{3}{4}$	4
2	24,600	19,265	15.90								
$2\frac{1}{4}$	32,300	25,295	15.40								
$2\frac{1}{2}$	39,800	31,169	14.90								

PROJECT INFORMATION		APPROVAL STAMP	
Project:		<input type="checkbox"/> Approved	
Address:		<input type="checkbox"/> Approved as noted	
Contractor:		<input type="checkbox"/> Not approved	
Engineer:		Remarks:	
Submittal Date:			
Notes 1:			
Notes 2:			